



# ***WELCOME***

***Congratulations*** on your purchase of a DAVCO®  
Manufacturing, Model HD706-EVO Brush Cutter with our new  
style disc designed with even less wear items!!  
The DAVCO® Brush Cutter, when combined with a Skid Steer  
or CTL with 31-45 GPM's, will provide you with unmatched  
durability, productivity and versatility.



As an Owner or Operator, it is your responsibility to learn the  
capabilities and limitations of the DAVCO® Brush Cutter to  
maximize both safety and performance. Before operating this  
DAVCO® product, make sure you read and understand this  
owner's manual. If you have any questions or comments  
regarding this or other DAVCO® products, don't hesitate to  
contact by phone (780) 532-0097 (1-877-532-4555), by fax @  
(780) 532-7101 or by e-mail: [davco@bardaequipment.com](mailto:davco@bardaequipment.com)



877-532-4555

davco@bardaequipment.com



## Personal & Property Safety

- Brush cutting, Mulching, Mowing, or other operations that can cause flying debris, can be a fire hazard in the carrier. With the engine off and cool, regularly inspect and clean the engine compartment and other areas where there may be hot or rotating parts. This should be performed as often as needed to prevent the combustion of this debris. Failure to do so could result in a fire, causing severe machine damage, injury or death.
- DO NOT operate DAVCO® Brush Cutters within 200 yards of living things or items susceptible to damage from flying debris or falling trees.
- DO NOT operate without safety approved shielding (door). Proper Personal Protective Equipment (i.e. Safety glasses, hard hat, dust mask, etc.) is highly recommended.
- Forestry rated door is required on your carrier.
- When the disc is rotating, DO NOT tilt the DAVCO® Brush Cutter so the knives are in line with the operator.
- Before servicing or leaving the cab be sure the hydraulics are disengaged, the engine is shut off, and the discs have come to a complete stop. (Note: to prevent run-on, try to stall the disc into the ground or brush after disengaging the hydraulics.)
- To remove debris from the brush cutter, the brush cutter must remain flat footed on the ground. Any other method may result in damage, injury or death.
- DO NOT straighten bent cutting knives. Straightening bent knives may cause cracking. Bent knives are to be replaced with new DAVCO® replacement blades.



877-532-4555

davco@bardaequipment.com

## **SPECIFICATIONS:**

**Attachment type: Industrial Brush Cutter**

**Model Number: HD706-EVO**

**Attachment Weight: 1850 lbs.**

**Required Hydraulic Flow: 31-45 gpm**

**Required Hydraulic Pressure: 3300 psi**

## **PLEASE NOTE:**

- **It is the responsibility of the owner/operator to inspect and maintain parts and equipment for the utmost reliability and safety.**
- **Periodically check all nuts and bolts for proper tightness and excessive wear.**
- **For the owner/operator's convenience, *DAVCO®* Manufacturing has provided a parts list in this operator's manual for replacement parts. *Factory Replacement parts are to be used to maintain warranty.***
- **Before shutting off the hydraulic motor, gradually throttle down to idle before disengaging the hydraulic valve. This helps to prevent cavitation in the hydraulic motor, and to help slow the cutting disc down; it can be stalled into the ground or brush after being disengaged.**

## 1. Start Up & Identification



Starting the DAVCO® Brush cutter: With the carrier motor running slightly above idle, to the engage. Throttle up gradually to the desired RPM. *Note: **The DAVCO® Brush Cutter's anti-cavitation block helps to prevent cavitation in the hydraulic motor and prevents the DAVCO® Brush Cutter from operating in reverse. Consult your carriers' operations & safety manual for directions of your own application.***

Fig 1-1

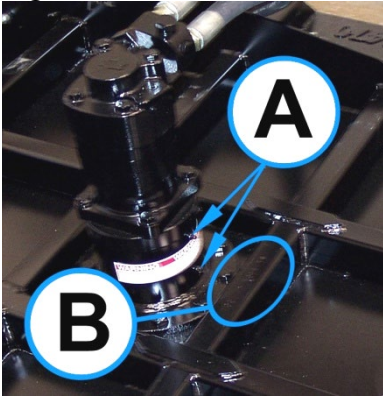
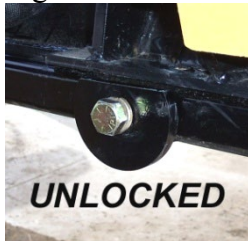

**Fig. 1-1 (B) shows: the identification of the DAVCO® Brush Cutter that includes the serial numbers and the model. Please refer to these numbers when calling for technical support, or replacement parts.**

## 2. Quick-Attach Lock

- *To properly mount the DAVCO® Brush Cutter to the Carrier, first make sure the carrier is shut down and key is removed. Refer to your carrier's operation & safety manual for installation instructions.*
- Always verify visually that the quick-attach Pins and Lock Plates are properly engaged and securely coupled to the attachment. (Note: Do not attempt to operate attachments with damaged or disengaged Pins or Lock Plates; equipment damage, property damage or serious injury could result.)

Fig. 2-1



- Fig. 2-1 shows the Lock Plate in the open (unlocked) position.

Fig. 2-2



- Turn the Lock Plate to the closed (locked) position (see Fig. 2-2) and tighten the bolt with a 1 1/8" wrench. Check often and re-tighten as necessary.

### 3. General Operations



*To prevent damage to your property, DAVCO® Brush Cutter/Mulcher or yourself inspect the work site prior to starting to cut, mow or mulch watching for and avoiding hidden obstacles such as animal carcasses, rocks, underground wires and other buried objects.*

3-1



\*For optimal performance, the DAVCO® Brush Cutter should be kept level with the ground during operation (see Fig. 3-1). \*Maintain a constant RPM on the DAVCO® Brush Cutter, using the travel speed of the carrier to determine the thoroughness of the cut. The slower that the carrier travels, the more complete the cut that the DAVCO® Brush Cutter will make, and the finer the mulch.

3-2



- \*Figure 3-2 shows a common position for the DAVCO® Brush Cutter during operation. This cutting position is also a very effective method of mulching debris into finer pieces. *Note: Excessive tilting of the DAVCO® Brush Cutter is not recommended, although slight tilting of the deck into the direction of travel can increase cutting efficiency.*

3-3



- Figures 3-3 demonstrates a method of brush cutting that is not recommended. Cutting in this manner throws debris outward and increases the likelihood of bending the cutting blades.

3-4



- *Never expose the underside of the DAVCO® Brush Cutter to the operator's cab (Fig. 3-5) or to personnel within sight of the machine. Flying debris can cause equipment damage, serious injury or death. Never exit cab while loader arms are raised.*



**CAUTION:** Before performing any maintenance, shut off carrier and disconnect brush cutter. Failure to do so may result in death or injury.

## Knife change

Fig. 4-1

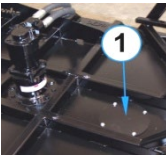

Remove the disc inspection cover (1) in Fig. 4-1 to gain access to the top of the disc. Rotate the disc by hand until the first set of knife bolts are visible in the hole. To remove the knives, stabilize the DAVCO® Brush Cutter on a stand or blocks, undo the nuts, drop the bolts, and then remove the knives and the pucks horizontally.

Fig. 4-2



To install the knives, reverse the procedure, and torque the bolts to 250 ft/lb for course thread bolts and 300 ft. lbs. for fine thread bolts.

***Note: Remember to re-torque the bolts after the first 8 hours of operation following a knife replacement and as required thereafter. For maximum Puck life put a coating of assembly grease around the outside of the puck.***

DAVCO® 1-877-532-4555 [www.davcomanufacturing.com](http://www.davcomanufacturing.com)

## 6. Maintenance Tips

6-1



**CAUTION:** Before performing any maintenance, shut off carrier and disconnect brush cutter. Failure to do so may result in death or injury.

- **Pucks** are to be inspected periodically and with every knife change for excessive wear. Rotate the pucks **1/3 of a turn** with each new knife and replace if necessary. Put a coating of assembly grease around the outside of the puck.
- **Knife bolts** to be inspected with every knife change for excessive wear or bending. Bolts have to be changed if any damage is found. **Torque the knife bolts to 300 Ft. Lbs. For Fine thread bolts.**
- Re-torque the knife bolts after the first 8 hours of use, and as required thereafter.
- **Flange nuts** are to be inspected and changed no less than every third knife change
- **Spindle bolts** (C) shown on Fig. (6-1) must be torqued to **350 ft/lb**. Inspect periodically.
- **Cutting Knives** (D) shown in Fig. 6-1 are to be inspected **daily** for sharpness, excessive wear or bending (If used while bent, damage to the bolts, pucks and discs may occur). DAVCO® knives can be sharpened or turned over. **Do not** straighten bent cutting knives, this may lead to crack & breaks.
- **Discs** need to be inspected at regular intervals. After excessive use cracks may appear, if this is the case the disc assemblies must be changed.
- **Housing bearings:** With the disc rotating at a low RPM, listen for rumbling or grinding sounds in the housing, which could be a sign of possible bearing failure.
- **Spindle Nut** (item #3, on Fig. 7-1) torque must not exceed **200 in/lb**. Excessive preload on bearings will cause premature failure. Check pre-load every 200hrs.
- **Housing to Deck Bolts** (Item #20 on parts list) Torque to 200 foot Lbs.
- **Grease Daily:** Four or five pumps of quality grease from a hand pump grease gun, which meet the NLGI GC/LB lubricant requirements to **each bearing's** grease nipple once a day minimum.





877-532-4555

davco@bardaequipment.com

**7. Parts List (HD706-EVO). Refers to Figs. 7-1, 7-2 & 7-3**

1	DV-258	1	Spindle Nut Lock Plate
2	DV-253A	1	Spindle Housing
3	DV-257	1	Spindle Retaining Nut
4	DV-255A	1	Spindle
5	DV-060	1	Bearing & Seal Kit
6	DV-302T	1	Top Disc
7	DV-303B	4	Puck
8	DV-705	4	Cutting Knife
9	DV-760	1	Knife Bolt Kit -Evo
10	DV-276 KIT	1	Spindle to Disc Bolt Kit
11	DV-767B	1	Bottom Disc Assy. - Evo
12	DV-320A	1	Spindle Bolt Guard
13	DV-208A KIT	4	Bolt
14	DV-305A	1	Disc Spacer
15	DV-201C	1	Anti-Cavitation Housing
16	DV-149	4	Hard Washer
17	DV-209	4	Bolt
18	DV-250	1	Drive Motor
19	DV-207	1	Check
20	DV-210 KIT	10	Bolt
21	DV-213	1	Grease Zerk
22	DV-204	1	Grease Zerk
23	DV-205A	4	Bolt
24	DV-206	1	Hex Head Plug
25	DV-214	2	O-Ring*
26	DV-242	4	Adapter
27	DV-H-904W	2	Hose
28	DV-559	1	Female Coupler*
29	DV-560	1	Male Coupler*
30	DV-003	2	Rod End kit
31	DV-700D	1	Guard Assembly (Safety/Swing Bar)
32	DV-270	1	Quick Attach Lock Plate & Hardware Assembly*
33	DV-121A	1	Inspection Cover *(Item #1 in Figure 4-1)

\* Not shown or hidden from view

Fig 7-1

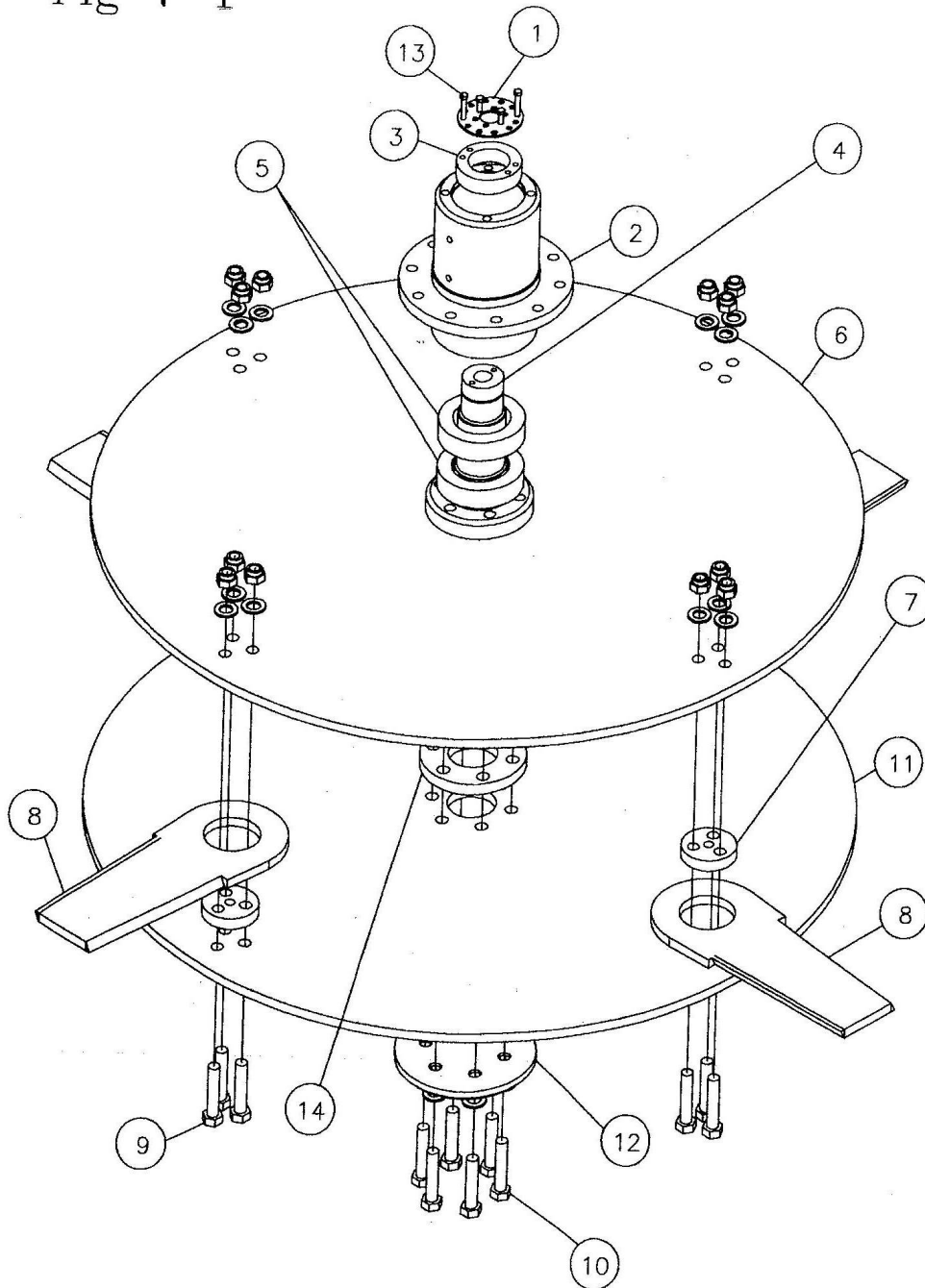

**Fig. 7-2**

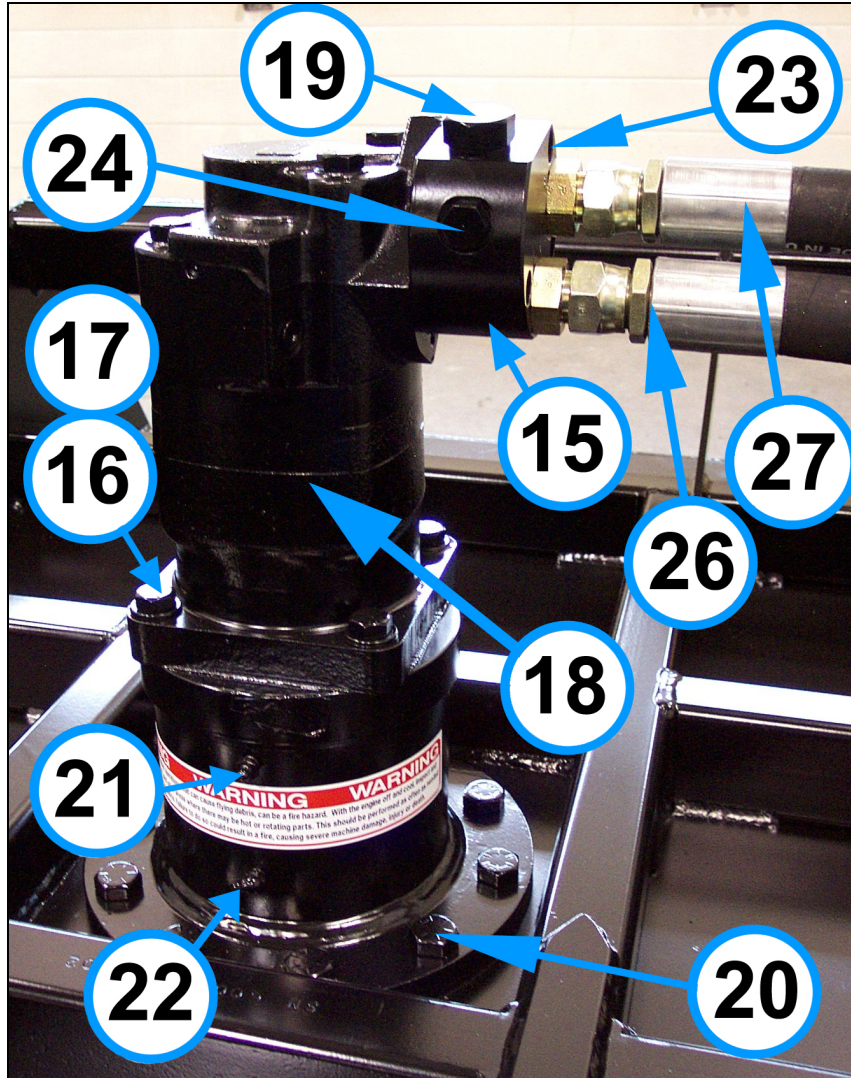
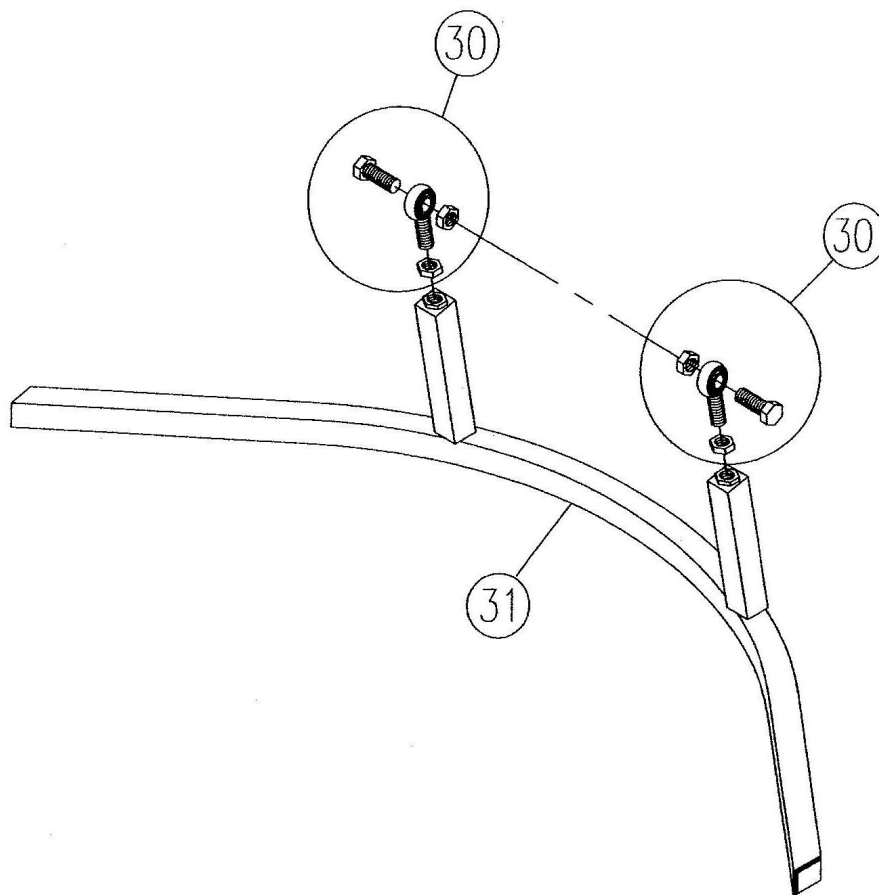

Fig 7-3





877-532-4555

davco@bardaequipment.com

**DAVCO®**  
**BRUSH CUTTER**  
***12 Month WARRANTY***

The warranty herein set forth applies solely to the **DAVCO®** Brush cutter.

Manufactured by **DAVCO®** Manufacturing Ltd. and is in lieu of all other warranties, expressed or implied. No person, agent, or dealer is authorized or empowered to give any other warranty or to assume any other liability on behalf of **DAVCO®** Manufacturing Ltd. The warranty is limited to the original purchaser only; no warranty is transferable to any subsequent owner.

**DAVCO®** Manufacturing Ltd. warrants the **DAVCO®** Brush Cutter against defects in material and workmanship under normal use and service for a period of One Year from the date of delivery, and will repair or replace at **DAVCO®** Manufacturing Ltd.'s discretion, free of charge to the original purchaser, any part that our examination reveals to be defective in material or workmanship. The warranty includes labour based on a flat rate, but does not include transportation costs, diagnosing time, clean up, or consequential damages. (Motor damage due to carrier hydraulic system contamination is not covered.)

**1. Only Original Equipment parts are covered by this warranty.**

**2. Wear items are not covered against normal use.**

**DAVCO®** Manufacturing Ltd. reserves the right to inspect components and or parts prior to any decision involving a warranty claim. In no case shall **DAVCO®** Manufacturing Ltd. grant a remedy that exceeds the purchase price of the component or part, and or the time to remove and or replace the component or part.

**DAVCO®** Manufacturing Ltd. reserves the right to make design changes without incurring any obligation to make such changes to previously manufactured equipment.

This warranty does NOT apply to damage caused by misuse, abuse, neglect (lack of lubrication), or improper adjustment, accident, or improper application. Any modifications or alterations made to the equipment without written authorization from **DAVCO®** Manufacturing Ltd. will void this warranty.

***NO OTHER WARRANTY OR GUARANTEE OF ANY KIND IS MADE BY DAVCO MANUFACTURING LTD. EXPRESSED OR IMPLIED, STATUTORY, BY OPERATION OR LAW, OR OTHERWISE, INCLUDING MERCHANTABILITY AND FITNESS FOR ANY PARTICULAR PURPOSE. DAVCO MANUFACTURING LTD. DISCLAIMS LIABILITY FOR DIRECT, INDIRECT, INCIDENTAL, OR CONSEQUENTIAL DAMAGES OF ANY KIND.***

**WARRANTY LIMITATIONS:**

**Modifications:** The limited warranty covers the **DAVCO®** Brush cutter as built by **DAVCO®** Manufacturing Ltd.



877-532-4555

[davco@bardaequipment.com](mailto:davco@bardaequipment.com)

**Carriers: CTL & Skid steers with adequate hydraulic flows & Forestry rated doors & cabs.**